



## Educational Technology Student Orientation to D2L

### Changing Your Font

#### Step 1

SELECT the **My Preferences** link from the Welcome Widget on your My Home page.

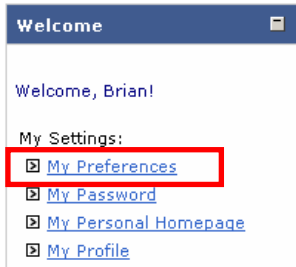

#### Step 2

SELECT the **General** tab.

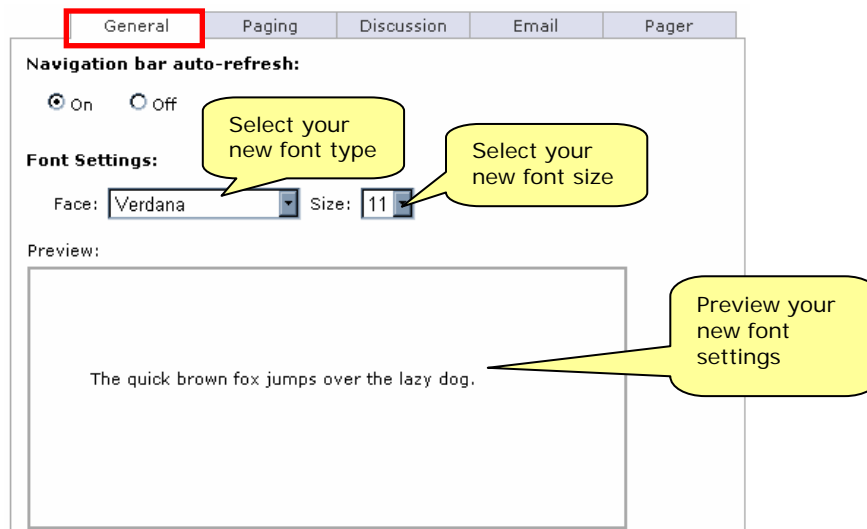

SELECT a new **font type** from the Face drop-down list.

SELECT a new **font size** from the Size drop-down list.

**Note:** You can preview your new settings in the Preview box.

CLICK the **Save** button.